

Drawing number / Rev  
B1297000-PH2/3000.01a/0017 C4

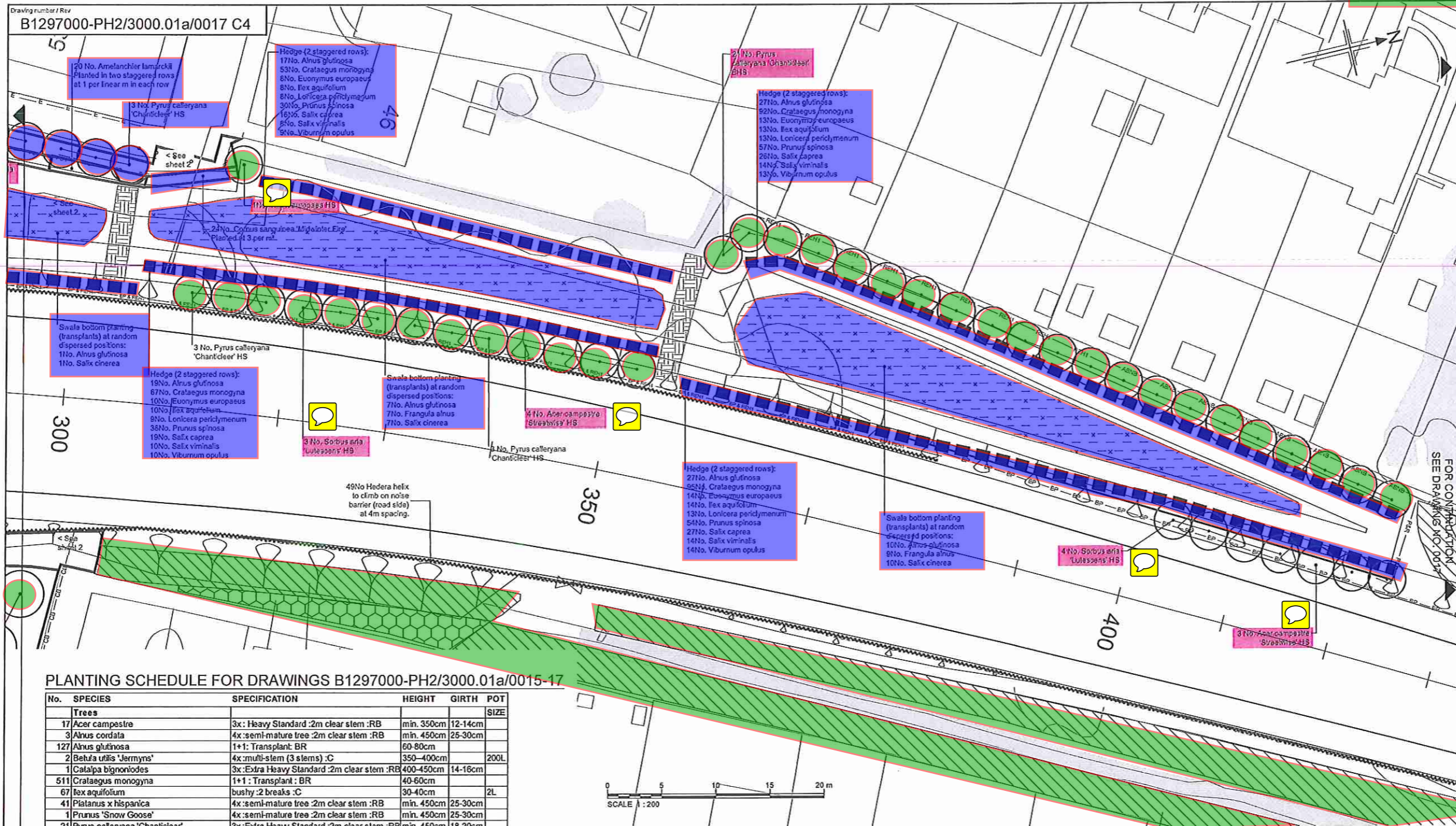

**NOTES**

- All dimensions in metres unless otherwise stated
- The fencing and noise barriers lay-out shown is due for revision. The planting lay-out shown matches the position of the noise barriers as constructed on site.

**KEY**

- Semi-mature or mu/s-stem tree
- Container grown tree or large shrub species planted without specified clear stem
- Planting plot boundary
- Planting zone in bottom of swale
- Self-clinging climbing plants to grow on noise barrier, roadside/trackside only. Species and quantities shown on planting drawings B1297000-PH2/3000.01a/0002 and 0003.
- EP — EP — 1.2m high timber post and wire fence with badger proofing (HCD/H13 + H46).
- AS/VS — 1.8m high absorptive noise barrier
- RE/H1 — 1.8m high reflective Noise Barrier
- FAR — Timber post and four rail fence (HCD/H3)

**SAFETY, HEALTH AND ENVIRONMENTAL INFORMATION**

In addition to the hazards/risks normally associated with the types of work detailed on this drawing, note the following:

**CONSTRUCTION**  
Likelihood of fly-tipped hazardous substances  
Existing overhead and underground high voltage cables  
Working near overhead power lines at dome/crossing point  
Working adjacent to a railway  
Working on slopes steeper than 1:3  
Working near to site plant and other machinery

**MAINTENANCE / CLEANING**  
Same as for construction

**DECOMMISSIONING / DEMOLITION**  
Same as for construction

It is assumed that all works will be carried out by a competent contractor working, where appropriate, to an approved method statement

Rev	Rev. Date	Purpose of revision	Drawn	Checked	Rev'd	Apprv'd
C4	03/12/2015	Planting revs	AS	RM	RM	PDF
C3	04/11/2015	Planting revs to match scheme changes	AS	RM	RM	PDF
C2	11/05/2015	Plant Schedule Updated to Match Changes	CC	AS	TD	JP
C1	02/03/2015	Rev. to match minor scheme layout changes	AS	RM	AS	JP
CO	26/07/2013	ISSUE FOR CONSTRUCTION	AS	RM	RM	AS

PLANTING SCHEDULE FOR DRAWINGS B1297000-PH2/3000.01a/0015-17

No.	SPECIES	SPECIFICATION	HEIGHT	GIRTH	POT SIZE
<b>Trees</b>					
17	Acer campestre	3x: Heavy Standard :2m clear stem :RB	min. 350cm	12-14cm	
3	Alnus cordata	4x: semi-mature tree :2m clear stem :RB	min. 450cm	25-30cm	
127	Alnus glutinosa	1+1: Transplant BR	60-80cm		
2	Betula utilis 'Jermyns'	4x: multi-stem (3 stems) :C	350-400cm		200L
1	Calyptra bignonioides	3x: Extra Heavy Standard :2m clear stem :RB	400-450cm	14-16cm	
511	Crataegus monogyna	1+1: Transplant : BR	40-60cm		
67	Ilex aquifolium	bushy :2 breaks :C	30-40cm		2L
41	Platanus x hispanica	4x: semi-mature tree :2m clear stem :RB	min. 450cm	25-30cm	
1	Prunus 'Snow Goose'	4x: semi-mature tree :2m clear stem :RB	min. 450cm	25-30cm	
21	Pyrus calleryana 'Chanticleer'	3x: Extra Heavy Standard :2m clear stem :RB	min. 450cm	18-20cm	
11	Pyrus calleryana 'Chanticleer'	3x: Heavy Standard :2m clear stem :RB	min. 350cm	12-14cm	
10	Sorbus aria 'Lutescens'	3x: Heavy Standard :2m clear stem :RB	min. 350cm	12-14cm	
2	Sorbus aucuparia	4x: semi-mature tree :2m clear stem :RB	min. 450cm	20-25cm	
3	Sorbus aucuparia	2x: Feathered: RB	min. 150cm		
10	Sorbus aucuparia	1+0: Transplant BR	60-80cm		
1	Tilia x europaea	3x: Heavy Standard :2m clear stem :RB	min. 350cm	12-14cm	
<b>Shrubs</b>					
1	Abutilon x suntense 'Jermyns'	branched :3 breaks :C	60-80-30cm		3L
3	Acacia baileyana	half standard : C	180-200cm		12L
140	Amelanchier lamarkii	Transplant 1+1: BR	60-80cm		
2	Amelanchier lamarkii	feathered :3 breaks :C	150-175cm		15L
393	Brachyglottis 'Sunshine' (Senecio 'Sunshir	branched :3 breaks :C	20-30cm		2L
252	Ceanothus 'Concha'	branched :3 breaks :C	20-30cm		2L
36	Choisya ternata	bushy :4 breaks :C	30-40cm		3L
600	Choisya ternata 'Aztec Pearl'	bushy :4 breaks :C	30-40cm		3L
318	Cistus ladanifer 'Pal'	bushy :4 breaks :C	30-40cm		3L
151	Cornus sanguinea 'Midwinter Fire'	branched :3 breaks :C	60-80cm		2L
50	Corylus avellana	1+2: branched :3 breaks :BR	60-80cm		
816	Coloneaster conspicuus 'Decorus'	branched :3 breaks :C	20-30cm		2L
654	Coloneaster dammeri	20-30cm diameter :bushy :3 breaks :C			2L
240	Coloneaster saicifolius 'Pendulus'	branched :2 breaks :C	40-60cm		3L
42	Eleagnus x ebbingel	branched :C	40-60cm		3L
2	Escallonia 'May'	bushy :C	40-60cm		3L
52	Euonymus europaeus	1+0: Bushy :3 brks :BR	40-60cm		
70	Forsythia intermedia 'Lyrwood'	branched :4 breaks :C	40-60cm		3L
21	Frangula alnus	Transplant 1Y: BR	40-60cm		
945	Griselinia littoralis	bushy :3 breaks :C	40-60cm		3L
584	Hebe 'Carl Teschner' (syn H. youngii)	bushy :3 breaks :C	30-40cm		2L
182	Hedera helix	Several Shoots	40-60cm		2L
6	Lonicera japonica 'Halliana'	Several Shoots :2 breaks :C	60-80cm		3L
800	Lonicera pileata 'Moss Green'	bushy :6 breaks :C	30-40cm dia		3L

Shrubs continued

NO. SPECIES	SPECIFICATION	HEIGHT	POT SIZE
50	Lonicera periclymenum	Several Shoots :2 breaks :C	60-80cm
30	Myrtus communis	bushy :C	40-60cm
371	Olearia x macrodonia	bushy :4 breaks :C	40-60cm
22	Philadelphus 'Belle Etoile'	branched :4 breaks :C	30-40cm
50	Philadelphus coronarius	branched :3 breaks :BR	40-60cm
42	Phlox fruticosa	bushy :C	40-60cm
207	Prunus spinosa	1+1 :Leader :BR	40-60cm
2	Rhus typhina 'Dissecta'	two shoots : C	60-80cm
128	Rosa rubiginosa	1+1: bushy, strong : BR	40-60cm
627	Rosmarinus officinalis 'Severn Sea'	bushy :3 breaks :C	30-40cm
102	Salix caprea	0/1 :Branched: 2 brks : BR	60-80cm
23	Salix cinerea	0/1 :Branched: 2brks : BR	60-80cm
53	Salix viminalis	0/1 :Branched :2 brks :BR	60-80cm
402	Spartium junceum	branched :3 breaks :C	40-60cm
304	Symphoricarpos x chenaultii 'Hancock'	0+1 :Branched: BR	40-60cm
95	Syringa vulgaris	1+1 : branched :2 breaks : BR	40-60cm
11	Syringa vulgaris 'Madame Lemoine'	branched :2 breaks :BR	60-80cm
98	Viburnum davidii	branched :2 breaks :C	20-30cm
189	Viburnum opulus	branched :2 breaks :BR	40-60cm
324	Viburnum tinus 'Eve Price'	bushy :4 breaks :C	30-40cm
46	Viburnum tinus	bushy :C	40-60cm
<b>Herbaceous Perennials, Grasses and Other Groundcover Plants</b>			
15	Acanthus spinosus	C	2L
15	Agapanthus 'Loch Hope'	C	1L
192	Bergenia purpurascens var. delavayi	C	2L
468	Geranium macrorhizum 'White-ness'	C	1L
80	Hypericum calycinum	C	0.5L
110	Miscanthus sinensis 'Morning Light'	C	3L
495	Pachysandra terminalis	C	1L



**JACOBS**  
Simpson House, 8 Cherry Orchard Road, Croydon, Surrey, CR9 6SE  
Tel: +44(0)208 665 8122 Fax: +44(0) 208 661 2459  
www.jacobs.com

Client: HOCHTIEF  
Employer: TAYLOR WOODROW

Project: BEXHILL TO HASTINGS LINK ROAD

Drawing title: PLANTING BELLE HILL SHEET 3 OF 3

Drawing status: FOR CONSTRUCTION

Scale: 1:200 @ A1 DO NOT SCALE  
Drawing number: B1297000  
Client no.: B1297000

Drawing number: B1297000-PH2/3000.01a/0017 C4  
Rev: 1

Reproduction from the Ordnance Survey Map with the permission of the controller of Her Majesty's Stationery Office Crown copyright reserved Licence No. AL 100017339