

Drawing number / Rev  
B1297000-PH2/3000.01a/0013 C2

FOR CONTINUATION,  
SEE DRAWING NO. 0008

**NOTES**

- All dimensions in metres unless otherwise stated.
- For complete fencing key, refer to fencing drawings.

**KEY**

- High Forest - Dry (Planting at 2m centres, random mix in groups of 3-5 of each species) (LE2.1 and LE2.4)
- High Forest - Dry (Planting at 2.5m centres, random mix in groups of 3-5 of each species) (LE2.1 and LE2.4)
- High Forest - Wet (Planting at 2m centres, random mix in groups of 3-5 of each species) (LE2.1 and LE2.4)
- High Forest - Wet (Planting at 2.5m centres, random mix in groups of 3-5 of each species) (LE2.1 and LE2.4)
- Dry Woodland Edge (3m wide, planting at approximately 1.2 - 1.6m centres in three staggered rows, random mix of 3-5 species (LE2.1 and LE2.4) Care must be taken not to plant in obvious or straight lines. Refer to plant spacing detail on drawing B1297000/3000.01a/0001
- Wet Woodland Edge (3m wide, planting at approximately 1.2 - 1.6m centres in three staggered rows, random mix of 3-5 species (LE2.1 and LE2.4) Care must be taken not to plant in obvious or straight lines. Refer to plant spacing detail on drawing B1297000/3000.01a/0001
- Scrub random mix in groups of 3 - 5 of each species (LE2.2)
- Wetland Scrub random mix in groups of 3 - 5 of each species (LE2.6)
- Existing Woodland to be managed (LE2.1.1)
- Existing Woodland Edge to be Managed (LE2.2)
- Scattered Trees in Wet Grassland, Marsh and Fen (LE6.4.1.1) Refer to plant spacing detail on drawing B1297000/3000.01a/0001
- Scattered Scrub in Neutral Grassland (LE6.1.3.1) Refer to plant spacing detail on drawing B1297000/3000.01a/0001
- Climbing plants on fences and structures - 4m linear spacing unless otherwise noted.
- Woodland/woodland edge infill planting
- Amenity Tree and Shrub Planting (LE3.1)
- Extra heavy standard, semi-mature tree or multi-stem tree
- Site of Special Scientific Interest (SSSI)
- Site of Nature Conservation Importance (SNCI)
- Native Species Hedgerows (LE4.3) Two staggered rows, planted at 0.5m centres, 0.5m between rows
- Native Hedgerows with Trees (LE4.4) Two staggered rows, planted at 0.5m centres, 0.5m between rows. Trees shall be planted in rows at an average of 10m - 15m centres. Each tree shall be marked/identified with a pole as described in Appendix 30.8.1 Planting, Setting out, sub-section 18 in Revision 9 (or later) of the Series 3000 Appendices.
- Ditch
- Watercourse
- Pond
- Public Footpath
- Byway
- Bridleway
- Existing trees, hedges & scrub to be retained
- Woodland management zones
- CPO boundary
- BF - Bat fence
- CB - 1.8m close boarded fence
- EP - Post and wire fence with badger proofing.
- P&R - Timber post and four rail fence
- ASNB - 1.8m high absorptive noise barrier
- REH1 - 1.8 & 1.5m high reflective noise barriers
- E - Existing fence
- SP - Stockproof fence

**MANAGEMENT OF SCRUB WOODLAND DR2:** Selective thinning/removal of some of the more vigorous species of scrub vegetation at 5 year intervals starting in Year 1 to retain a balance of scrub and open patches with herbaceous flora. Biennial cutting of herbaceous layer in open patches, removing the clippings to maintain/encourage the growth and diversity of fenland and chalkland species. (Cutting in Years 1, 3 and 5 as part of this contract, and by ESCC in Year 7). Annual monitoring and removal/control of alien invasive species.

- Plot 13.1
- Native Hedgerow 42No Car bell 60-80cm
  - 205No Cor ova 40-60cm
  - 1235No Cranes 40-60cm
  - 42No Evon eur 40-60cm
  - 62No He opa 30-40cm
  - 103No Lon per 30-40cm
  - 226No Prn spl 40-60cm
  - 63No Rix ces 40-60cm
  - 62No Sil cap 60-80cm
  - 42No Vb opa 40-60cm

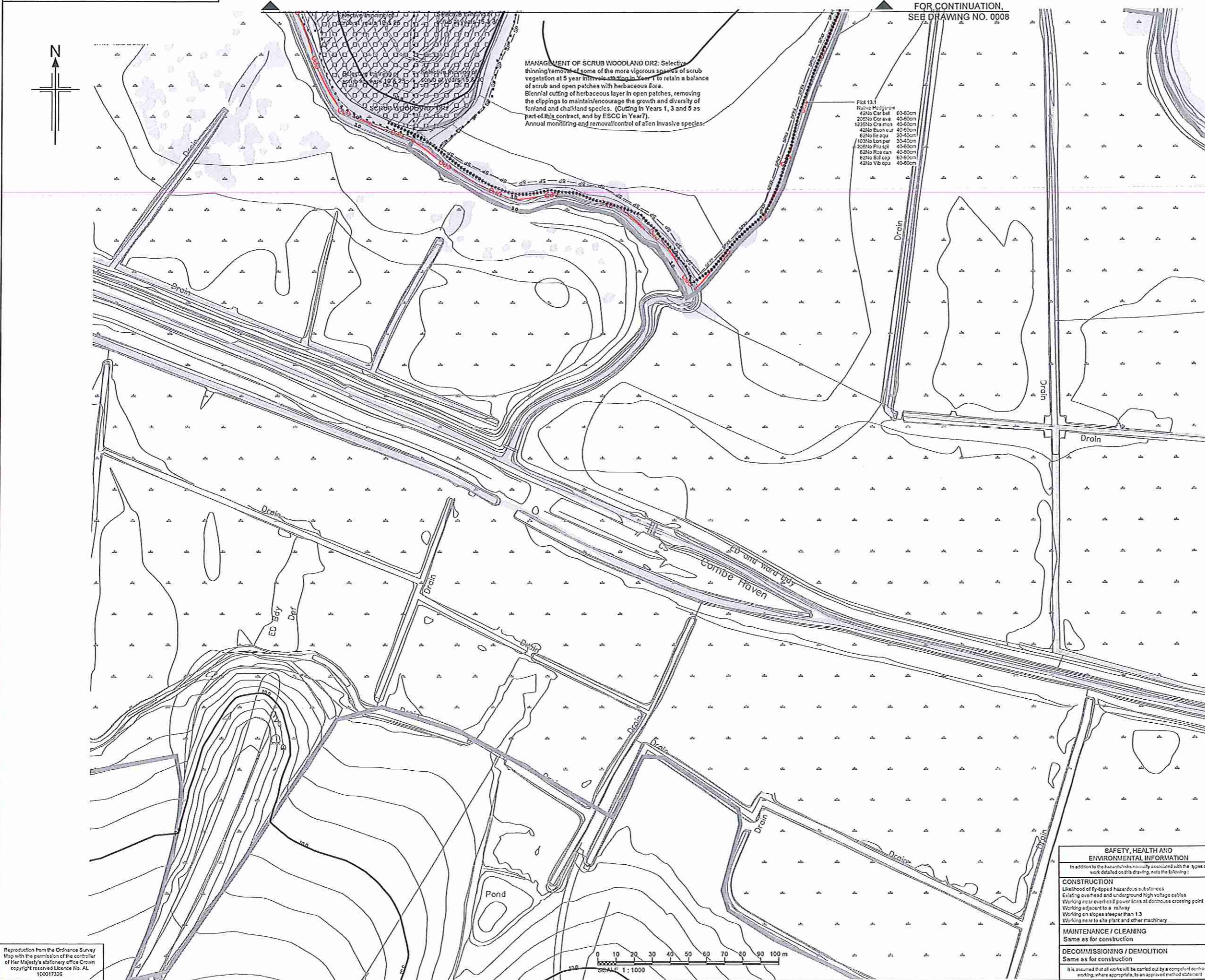
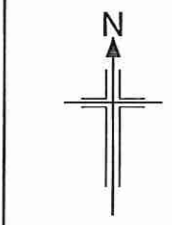

Reproduction from the Ordnance Survey Map with the permission of the controller of Her Majesty's Stationery Office Crown copyright reserved Licence No. AL 100017328



**SAFETY, HEALTH AND ENVIRONMENTAL INFORMATION**

In addition to the hazards/risks normally associated with the types of work detailed on this drawing, note the following:

**CONSTRUCTION**

- Likelihood of fly-tipped hazardous substances
- Existing overhead and underground high voltage cables
- Working near overhead power lines at dangerous crossing point
- Working adjacent to a railway
- Working on slopes steeper than 1:3
- Working near to site plant and other machinery

**MAINTENANCE / CLEANING**

Same as for construction

**DECOMMISSIONING / DEMOLITION**

Same as for construction

It is assumed that all works will be carried out by a competent contractor working, where appropriate, to an approved method statement

Rev	Rev. Date	Purpose of revision	Drawn	Checked	Rev'd	Approved
C2	15/12/2015	Minor revisions to key and graphics	LC	AS	AS	PDF
C1	11/08/2015	Plant Schedule Updated to Match Changes	CC	AS	TD	JP
CD	26/07/2013	ISSUE FOR CONSTRUCTION	AS	FM	FM	AB

**JACOBS**  
Empson House, 8 Cherry Orchard Road, Croydon, Surrey, CR9 4EE  
Tel: +44(0)208 688 8112 Fax: +44(0) 208 681 2499  
www.jacobs.com

Client: HOCHTIEF  
Employer: TAYLOR WOODROW

Project: BEXHILL TO HASTINGS LINK ROAD

Drawing title: PLANTING SHEET 13 OF 14

Drawing status: FOR CONSTRUCTION

Scale	1:1000 @ A1	DO NOT SCALE
Jacobs No.	B1297000	
Client no.		
Drawing number	B1297000-PH2/3000.01a/0013	Rev C2

This drawing is not to be used in whole or part other than for the intended purpose and project as defined on this drawing. Refer to the contract for full terms and conditions.

11 JAN 2016  
N553