

B1297000-PH2/3000.01a/0015 C4

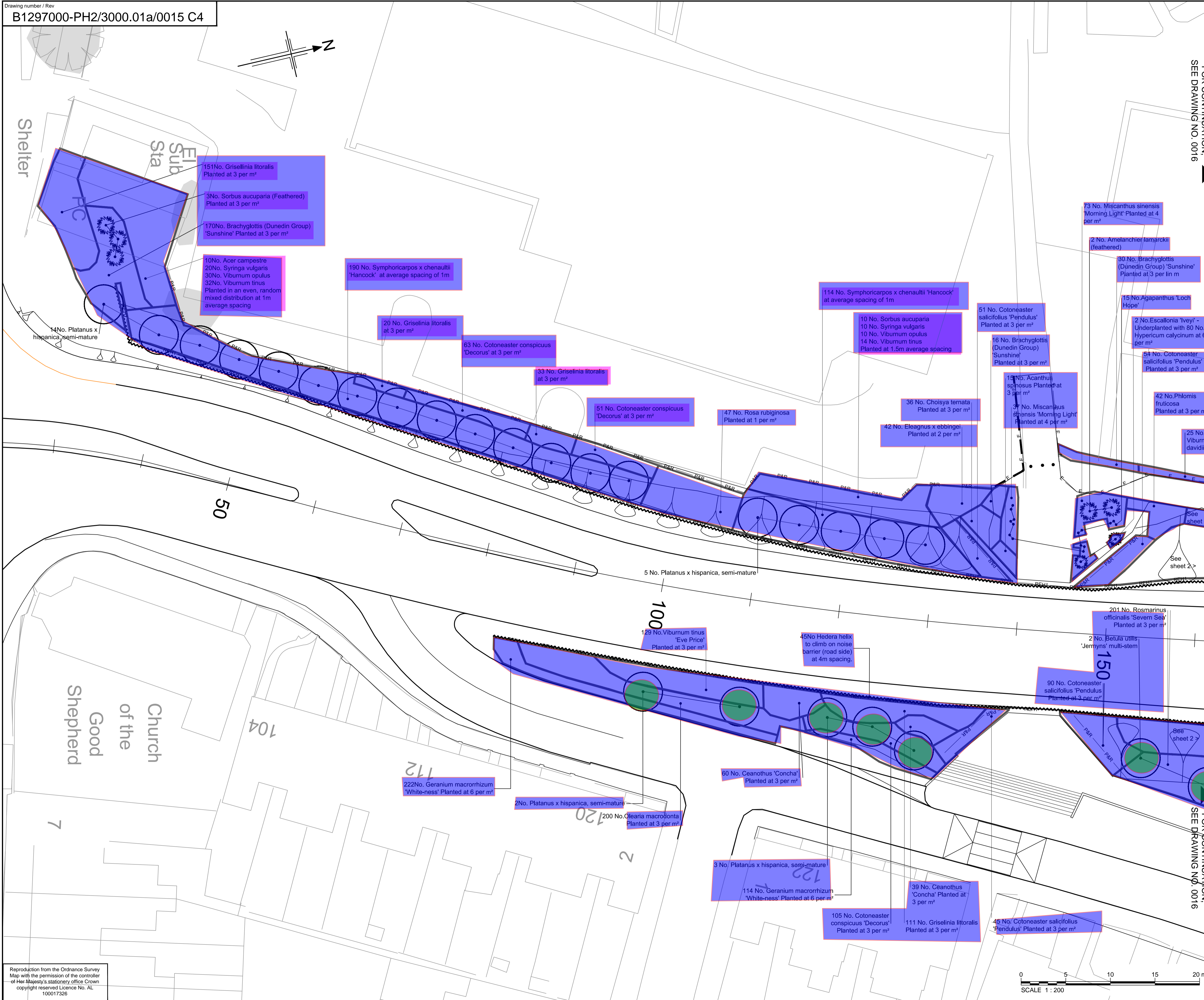

NOTES

- All dimensions in metres unless otherwise stated
- The fencing and noise barriers lay-out shown is due for revision. The planting lay-out shown matches the position of the noise barriers as constructed on site..

KEY

- Semi-mature or multi-stem tree
- Container grown tree or large shrub species planted without specified clear stem
- Planting plot boundary
- Self-clinging climbing plants to grow on noise barrier, roadside/trackside only. Species and quantities shown on planting drawing B1297000-PH2/3000.01a/0002.
- 1.2m high timber post and wire fence with badger proofing (HCD/H13 + H46).
- 1.8m high absorptive noise barrier
- 1.8m high reflective Noise Barrier
- Timber post and four rail fence (HCD/H3)

FOR CONTINUATION, SEE DRAWING NO. 0016

FOR CONTINUATION, SEE DRAWING NO. 0016

Note: The planting schedule for this drawing is on drawing B1297000-PH2/3000.01a/0017

| SAFETY, HEALTH AND ENVIRONMENTAL INFORMATION   |  |
|--|--|
| In addition to the hazards/risks normally associated with the types of work detailed on this drawing, note the following:  |  |
| <b>CONSTRUCTION</b><br>Likelihood of fly-tipped hazardous substances<br>Existing overhead and underground high voltage cables<br>Working near overhead power lines at dormouse crossing point<br>Working adjacent to a railway<br>Working on slopes steeper than 1:3<br>Working near to site plant and other machinery |  |
| <b>MAINTENANCE / CLEANING</b><br>Same as for construction  |  |
| <b>DECOMMISSIONING / DEMOLITION</b><br>Same as for construction  |  |
| It is assumed that all works will be carried out by a competent contractor working, where appropriate, to an approved method statement   |  |

| Rev | Rev. Date  | Purpose of revision                       | Drawn | Checked | Rev'd | Appr'd |
|-----|------------|---|-------|---------|-------|--------|
| C4  | 03/12/2015 | Planting revs                             | AS    | RM      | RM    | PDF    |
| C3  | 04/11/2015 | Planting revs to match scheme changes     | AS    | RM      | RM    | PDF    |
| C2  | 11/08/2015 | Plant Schedule Updated to Match Changes   | CC    | AS      | TD    | JP     |
| C1  | 02/03/2015 | Rev. to match minor scheme layout changes | AS    | RM      | AB    | JP     |
| C0  | 26/07/2013 | ISSUE FOR CONSTRUCTION                    | AS    | RM      | RM    | AB     |

**JACOBS**  
Simpson House, 6 Cherry Orchard Road, Croydon, Surrey, CR9 6BE  
Tel: +44(0)208 686 8212 Fax: +44(0) 208 681 2499  
www.jacobs.com

Client: **HOCHTIEF** Employer: **TEYLAB WOODROW**

Project: BEXHILL TO HASTINGS LINK ROAD

Drawing title: **PLANTING BELLE HILL SHEET 1 OF 3**

Drawing status: **FOR CONSTRUCTION**

Scale: 1:200 @ A1 DO NOT SCALE  
Jacobs No. B1297000  
Client no.

Drawing number: **B1297000-PH2/3000.01a/0015** Rev: **C4**  
This drawing is not to be used in whole or part other than for the intended purpose and project as defined on this drawing. Refer to the contract for full terms and conditions.

P:\BTL\008\B1297000 Bexhill Hastings\Phase 2 - Detailed Design\600 CAD\603 Drawings\3000 Landscape & Ecology

Reproduction from the Ordnance Survey Map with the permission of the controller of Her Majesty's stationery office Crown copyright reserved Licence No. AL 100017326