

Note: Planting represents year 15

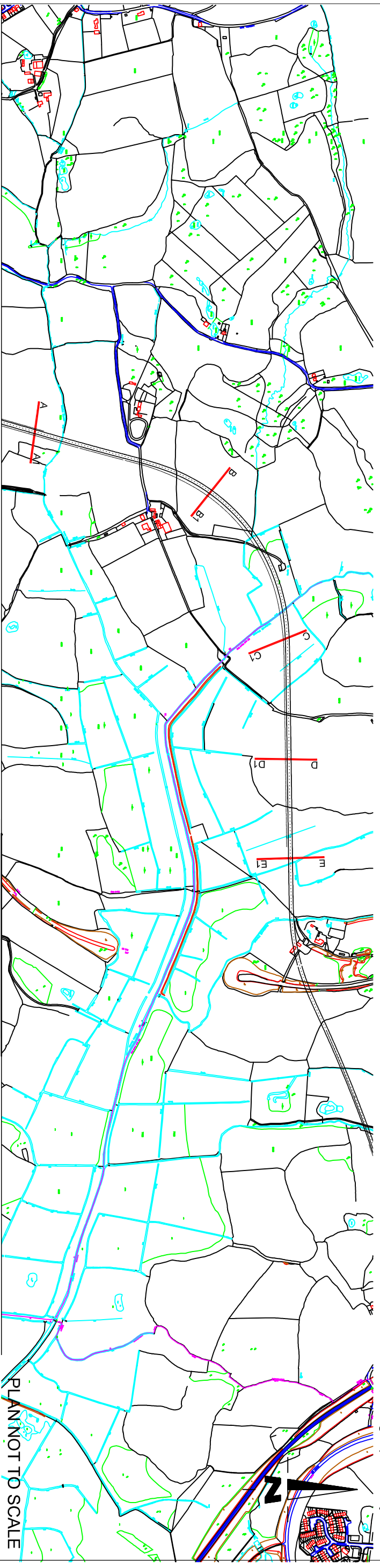

This map is reproduced from Ordnance Survey material with the permission of Ordnance Survey on behalf of the Controller of Her Majesty's Stationery Office & Crown Copyright. Unauthorised reproduction infringes Crown Copyright and may lead to prosecution or other proceedings. OSN07/0807; Edin P13/000001; P4411/0001.

BEXHILL TO HASTINGS LINK ROAD

Figure : 13.18 B		Scale	1 : 500 @ A3
Cross Sections of the Scheme		Sheet	2 of 2
		Revision	

Carolin Dwyer BEng (Hons), DipTrans, OHS,
MILT MILT
Assistant Director, Transport & Waste
County Hall, St. Anne's Green
Lewes, East Sussex BN1 7UE
Telephone 01273 461000

Transport & Environment