

**PART PLAN OF PROPOSED BRIDGE**  
SCALE 1:100

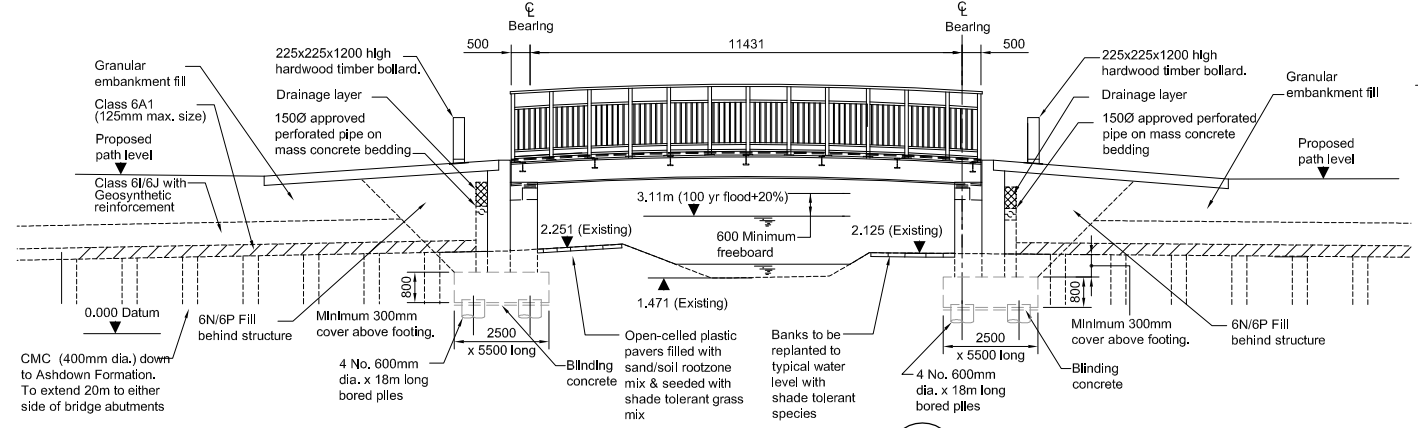

**SECTIONAL ELEVATION (A)**  
SCALE 1:100

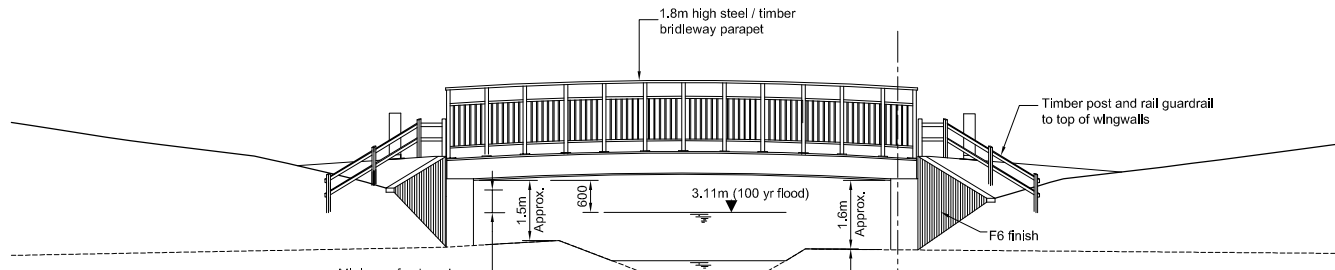

**TRUE ELEVATION**  
SCALE 1:100

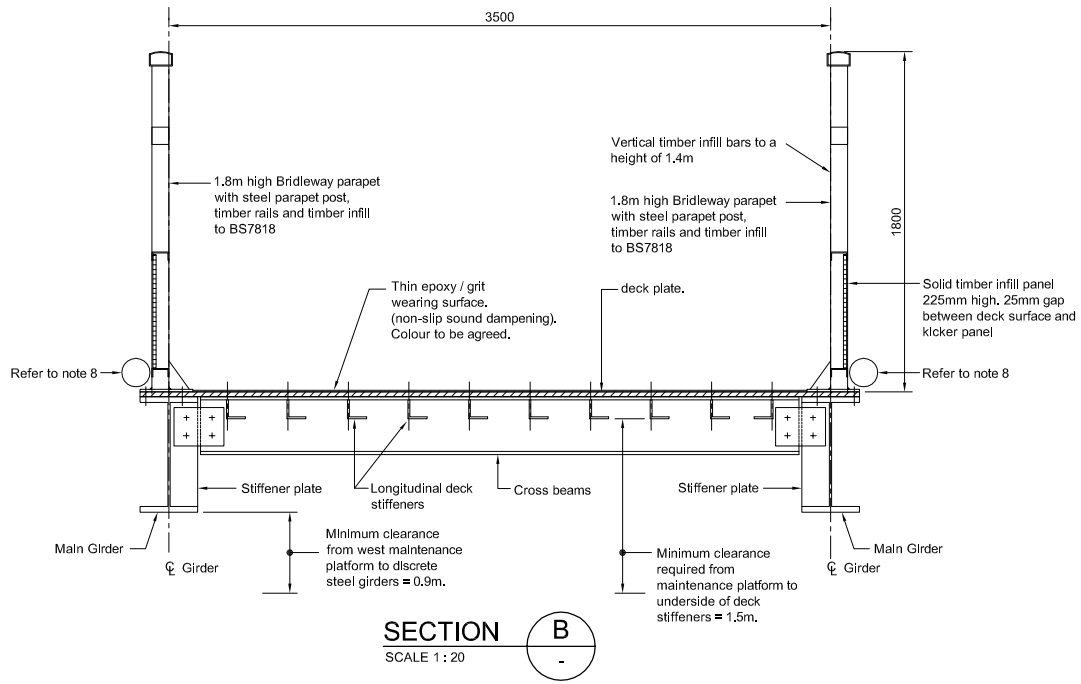

**SECTION (B)**  
SCALE 1:20

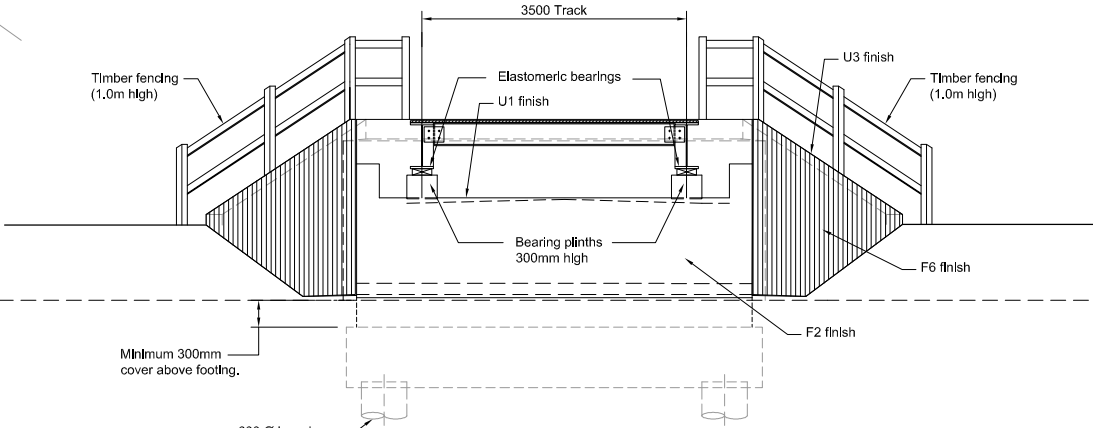

**TYPICAL ELEVATION OF ABUTMENT**  
SCALE 1:50

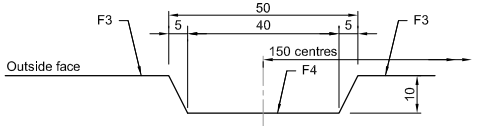

**DETAIL (A)**  
SCALE 1:1

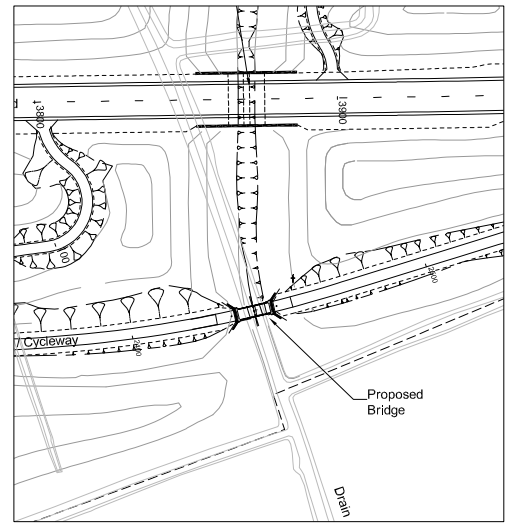

**SITE LOCATION**  
SCALE 1:1250

- Notes**
- All dimensions in millimetres unless noted otherwise.
  - All levels in metres A.O.D. (Above Ordnance Datum - Newlyn).
  - Structural element dimensions are approximate and subject to change during detailed design.
  - Bridge deck will be a proprietary product.
  - Temporary jacking points will be in line with existing bearings below end diaphragm.
  - Cross beam and Longitudinal deck stiffener spacing to be confirmed during detailed design.
  - Timber elements in parapet system to be Ekki hardwood with natural finish.
  - Dormouse crossings shall be provided across each side of the structure. These shall consist of 75-100mm diameter galvanised or plastic-coated wire mesh tubes with sisal rope inserts. The mesh tubes shall be located on the parapet coping beam at the base of the parapet system on the traffic face and shall be securely fastened to the posts using stainless steel jubilee clip fasteners. The mesh tubes shall be extended to the vegetation on the approach embankment slopes.
  - Concrete finishes are as described in the Specification for Highway Works Series 1700.
  - Structural steelwork in deck to be Type II to the Specification for Highway Works Series 1900.

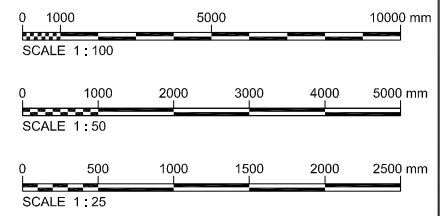

RO	26/10/12	ISSUED FOR PLANNING	JEB	PB	PB	SG
Rev	Rev. Date	Purpose of revision	Drawn	Checked	Rev'd	Apprv'd
<b>JACOBS</b>						
Simpson House, 6 Cherry Orchard Road, Croydon, CR9 6BE Tel: +44(0)208 686 8212 Fax: +44(0)208 681 2499 www.jacobs.com						
Client	HOCHTIEF/VINCI JOINT VENTURE					
Employer	EAST SUSSEX COUNTY COUNCIL					
Project	BEXHILL TO HASTINGS LINK ROAD					
Drawing title	POWDERMILL VALLEY STREAM UNDERBRIDGE GENERAL ARRANGEMENT					
Drawing status	FOR REVIEW					
Scale	AS SHOWN @ A1		DO NOT SCALE			
Jacobs No.	B1297000					
Client no.						
Drawing number	B1297000-PH2/1700.01A/9171					Rev
						R0